

The diagram to the left shows only a possible setup - often the most capacity and/or the most comfortable. Most setups are able to be adjusted for client's specific needs. Actual placement may vary slightly.

When submitting a setup request: It is acceptable to select or reference the most similar setup option and then list any preferred adjustments. We will always work one-on-one with clients to confirm all setup needs and requests.

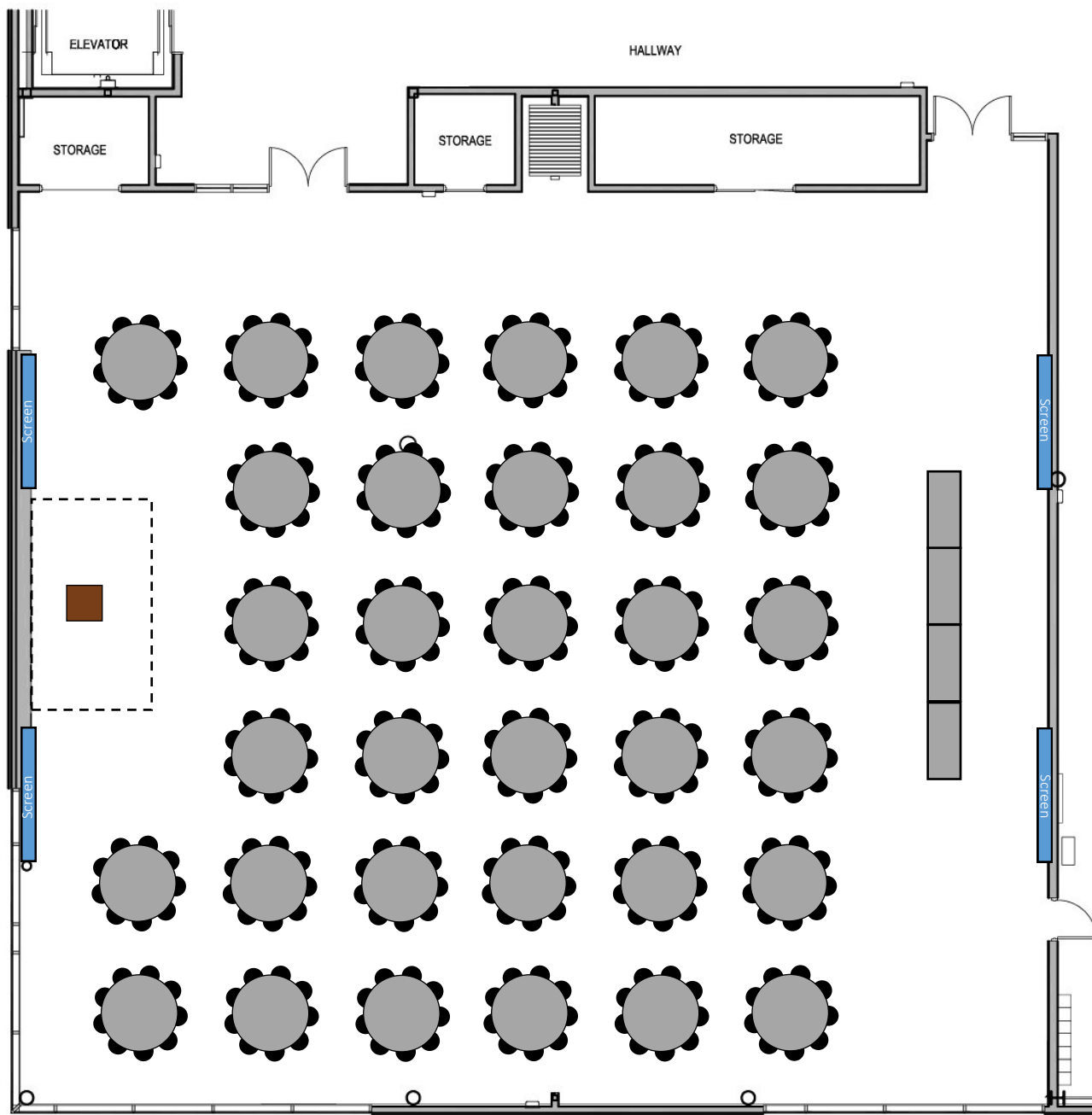

The diagram to the left shows only a possible setup - often the most capacity and/or the most comfortable. Most setups are able to be adjusted for client's specific needs. Actual placement may vary slightly.

When submitting a setup request: It is acceptable to select or reference the most similar setup option and then list any preferred adjustments. We will always work one-on-one with clients to confirm all setup needs and requests.

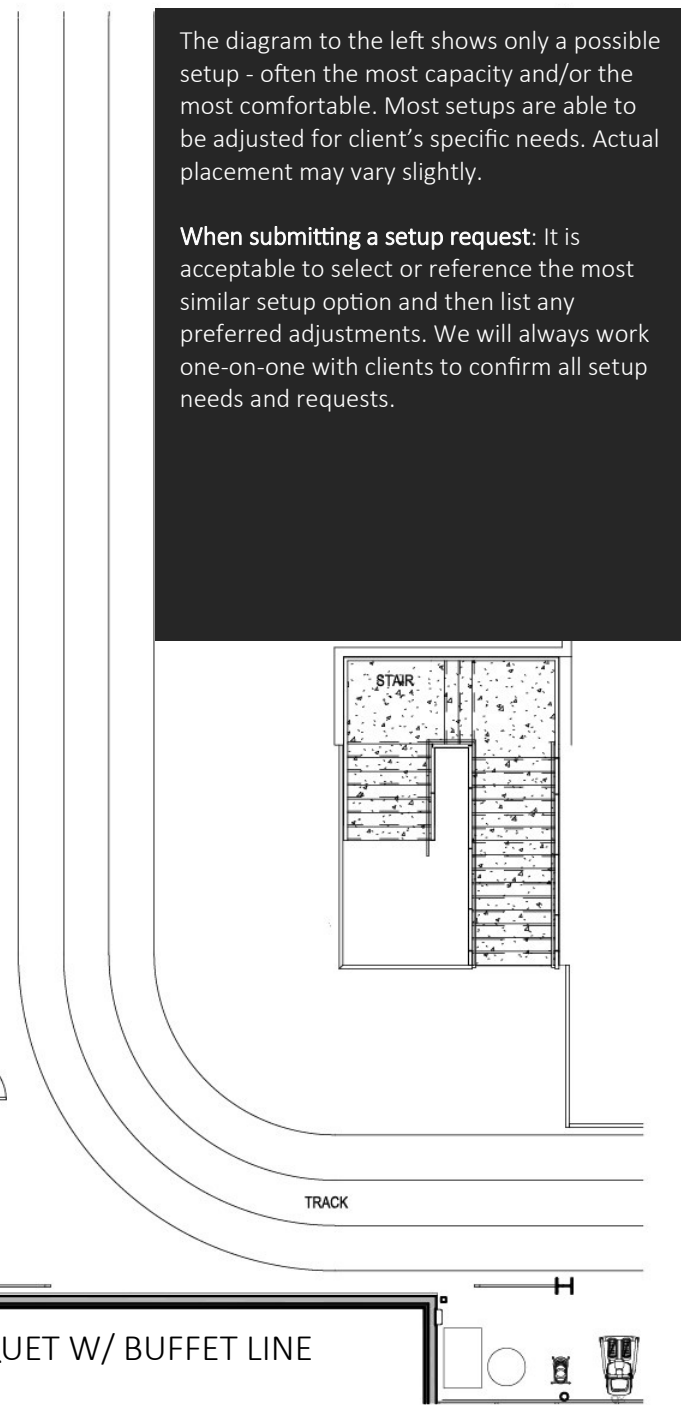

FULL STUDENT ASSEMBLY (UWY 303 & 304) / OPTION C - BANQUET W/ BUFFET LINE

6' Round Tables: 33
 6' Rectangular Tables: Up to 6
 Chairs: 297

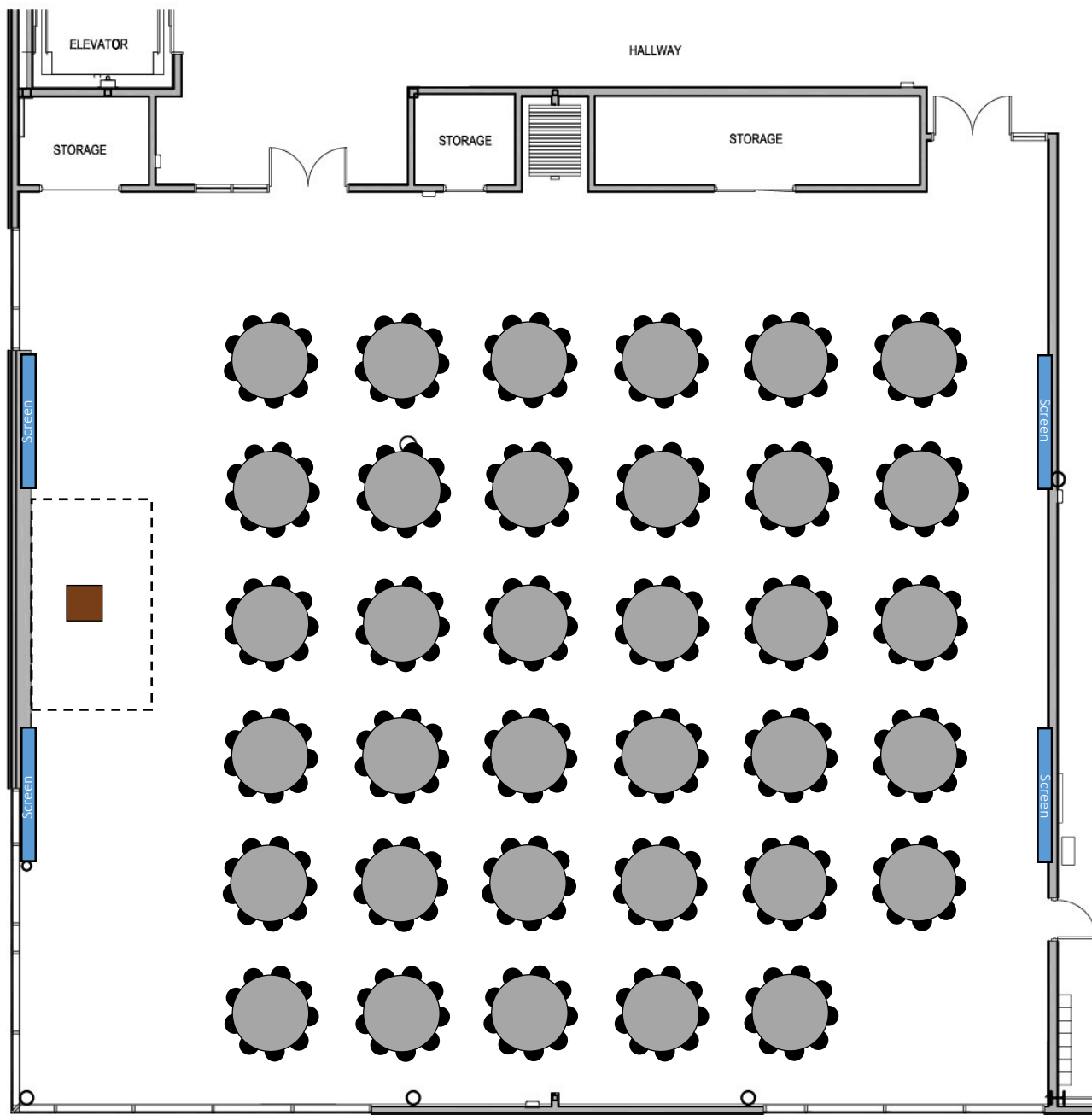

The diagram to the left shows only a possible setup - often the most capacity and/or the most comfortable. Most setups are able to be adjusted for client's specific needs. Actual placement may vary slightly.

When submitting a setup request: It is acceptable to select or reference the most similar setup option and then list any preferred adjustments. We will always work one-on-one with clients to confirm all setup needs and requests.

FULL STUDENT ASSEMBLY (UWY 303 & 304) / OPTION D - BANQUET

6' Round Tables: 35

Chairs: 315

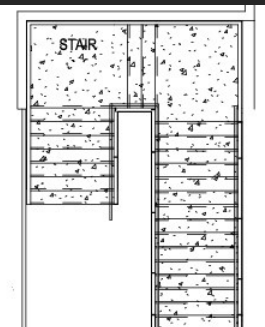

TRACK

H

NORTH →

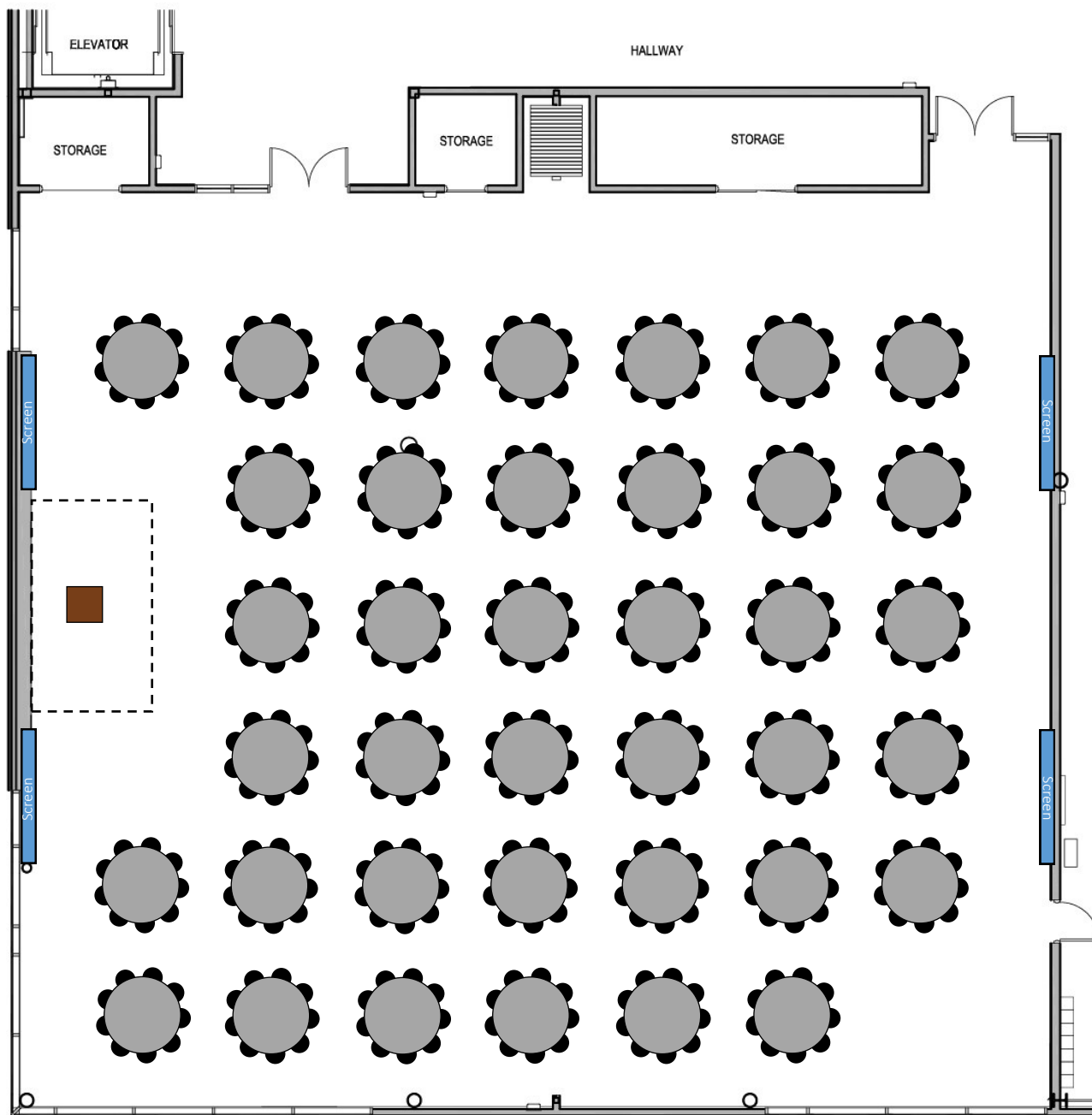

The diagram to the left shows only a possible setup - often the most capacity and/or the most comfortable. Most setups are able to be adjusted for client's specific needs. Actual placement may vary slightly.

When submitting a setup request: It is acceptable to select or reference the most similar setup option and then list any preferred adjustments. We will always work one-on-one with clients to confirm all setup needs and requests.

FULL STUDENT ASSEMBLY (UWY 303 & 304) / OPTION E - BANQUET

6' Round Tables: 38

Chairs: 342

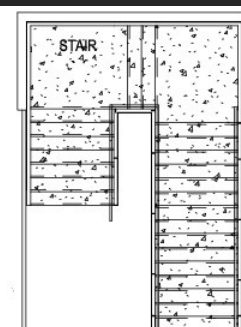

TRACK

H

NORTH →

